

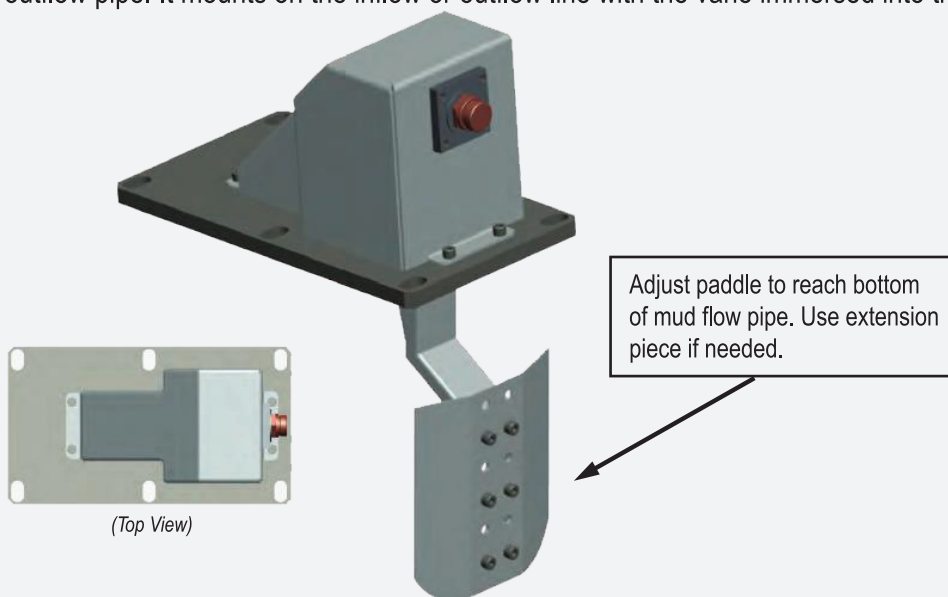

ASDH Mud Flow Transmitter Installation Procedure

With Innovative Non-Contact Gap Sensing Technology

The Advanced Sensor Design “MFT” Mud Flow Transmitter is an innovative vane-type (paddle) meter that measures mud flow through the drilling mud inflow or outflow pipe. It mounts on the inflow or outflow line with the vane immersed into the mud flow.



The Mud Flow Transmitter is designed to go between the shaker and the well head.

1. Find location with a removable cover and mounting area
2. Remove Flange Cover on mud flow pipe
3. Test fit Flow Transmitter and adjust length of the paddle
 - 1) Must touch to bottom of the pipe with no flow
 - 2) You may need to adjust the screws and possibly add the extension bar.
4. Next secure the base plate to the pipe using bolts. Dimensions are on page (2) if needed.
5. Once the Flow Transmitter is mounted in place do a two point calibration.
 - 1) You low point will be with No Flow, paddle down.
 - 2) Turn on the mud flow to a known flow rate and make that your second calibration point.

Now you are all set to monitor Mud Flow.

REV A - 2/13/2017